

Paper Dispenser

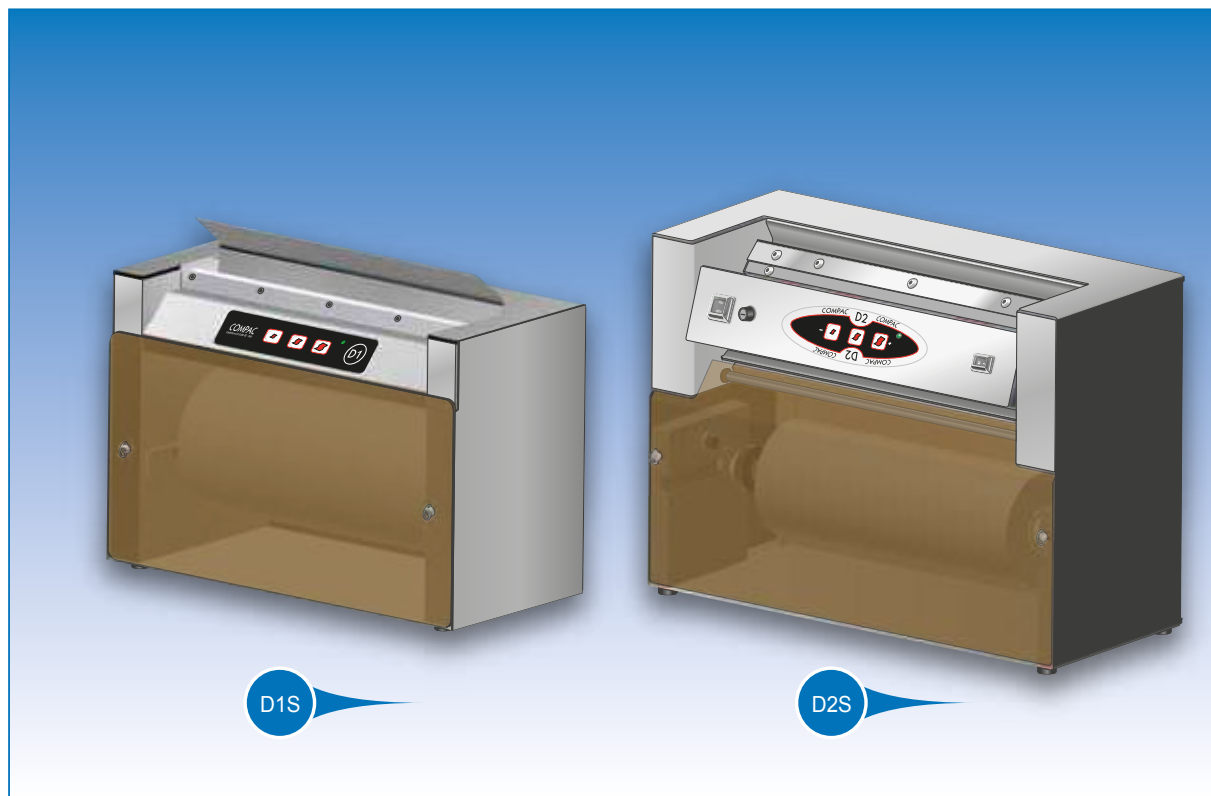

D1S

D2S

D1S

STAINLESS STEEL

DATA SHEET

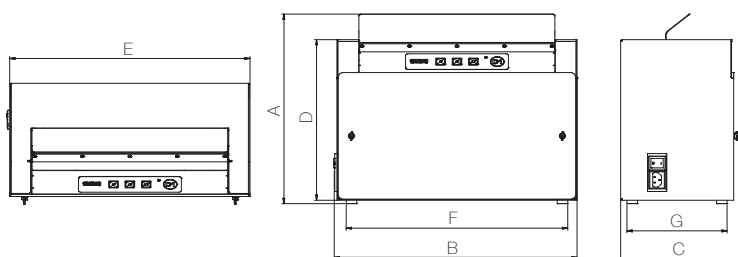

- Total weight: 14,5 Kg. approx. (without reel)
 - Power supply: single-phase + earth
 - Power voltage: 220 V \pm 10%
 - Power frequency: 50 Hz
 - OVERALL DIMENSIONS mm:
A: 354 B: 460 C: 230 D: 302 E: 455,5
 - MINIMUM DIMENSIONS OF WORKTABLE mm:
F: 420 G: 190
 - Format and Film reel used:
PAPER ROLL
width 350mm - MAX \varnothing 200mm.
- STANDARD MEASUREMENTS OF THE THREE SIZES cm:
small: 27x35 - average: 40x35 - large: 50x35

D2S

STAINLESS STEEL

DATA SHEET

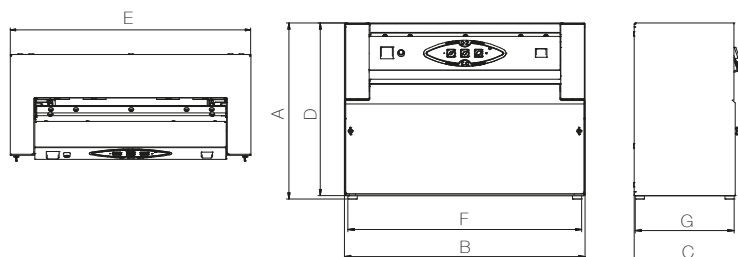

- Total weight: 21,5 Kg. approx. (without reel)
 - Power supply: single-phase + earth
 - Power voltage: 220 V \pm 10%
 - Power frequency: 50 Hz
 - OVERALL DIMENSIONS mm:
A: 385 B: 526 C: 234,5 D: 378 E: 526
 - MINIMUM DIMENSIONS OF WORKTABLE mm:
F: 511 G: 216,5
 - Format and Film reel used:
PAPER ROLLS
width 350mm - MAX \varnothing 200mm.
width 400mm - MAX \varnothing 190mm.
- STANDARD MEASUREMENTS OF THE THREE SIZES cm:
with "L" selection: 27,40,50
with "H" selection: 33,52,64
NOTE: the machine can be set directly by the operator to unwind any length of paper between 20 and 80cm

No responsibility is implied or may be linked to this catalog.

All technical data does not have scientific value and are reported only for the purpose technical / application of the product.

Technological suitability: the product must always be verified by the user as regards the technological suitability referring to the production process, the packaging environment and the food to be packaged.